

S-601(B-064.100)  
S-605(B-064.200)

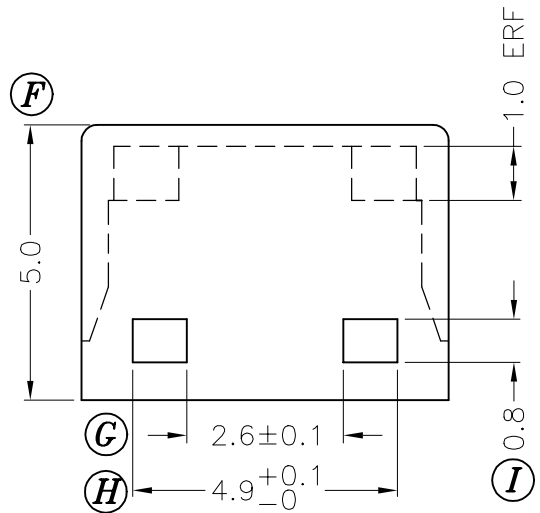
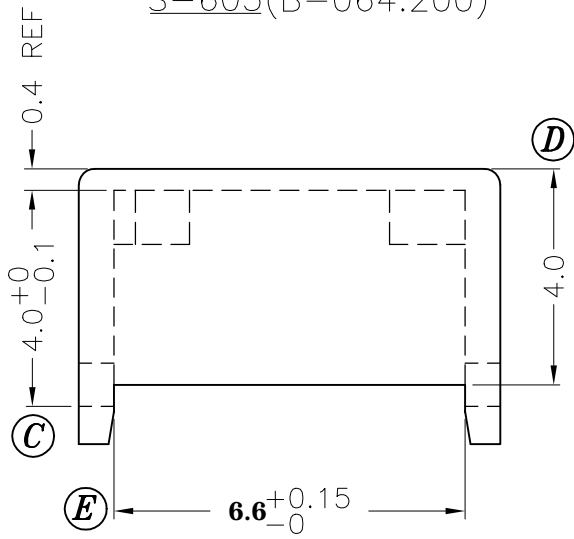
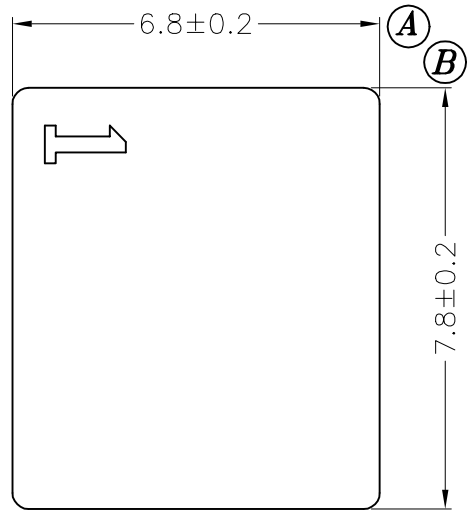

C-064.001L(B-064C)

REV.	REVISIONS	REC.	REV.	REVISIONS	REC.

DRAWN & DRAFTED BY WANG CHENG	TOLERANCES		ANGLE: ±1°	TITLE: COVER EE-6.3	
	0<L≤4 ±0.1	pin pitch	UNIT: MM	BOBBIN MATERIAL: LCP E4008	UL REC. UL 94V-0
CHECKED & APPROVED BY JOHN RONG	4<L≤16 ±0.2		ORIGIN: DG	PIN MATERIAL:	PIN TENSION LOAD:
<b>PIN SHINE INDUSTRIAL CO., LTD.</b> TEL:886-2-22990545      FAX:886-2-22990546			DATE: JAN.30 '2002	DRAWING NO. C-064	REV. 0